

# ARMOUR®

Reliable quality

## ANCHORS, HANGERS & SUPPORTS PRODUCTS



HANGERS.....	1
RISER CLAMP .....	3
BEAM CLAMP.....	4
STRUT CHANNEL & ACCESORIES .....	5
ANCHORS.....	9
RODS & HARDWARE.....	11
SWAY BRACING .....	12

### MODEL LOOP LOOP HANGER

MATERIAL: Electro-galvanized Steel  
APPLICATION: Adjustable band hanger.

CAT #	SIZE	ROD SIZE	MAX LOAD (Lbs)
HS-LOOP-0050-EG	1/2"	3/8"	400
HS-LOOP-0075-EG	3/4"	3/8"	400
HS-LOOP-0100-EG	1"	3/8"	400
HS-LOOP-0125-EG	1 1/4"	3/8"	400
HS-LOOP-0150-EG	1 1/2"	3/8"	400
HS-LOOP-0200-EG	2"	3/8"	400
HS-LOOP-0250-EG	2 1/2"	3/8"	1000
HS-LOOP-0300-EG	3"	3/8"	1000
HS-LOOP-0400-EG	4"	3/8"	1100
HS-LOOP-0500-EG	5"	1/2"	1250
HS-LOOP-0600-EG	6"	1/2"	1250
HS-LOOP-0800-EG	8"	1/2"	1250

UL EX 15800  
FM 3048552



### MODEL CLV CLEVIS HANGER

MATERIAL: Electro-galvanized Steel  
APPLICATION: For suspension of stationary pipe lines.

CAT #	SIZE	MAX LOAD (Lbs)
HS-CLV-0050-EG	1/2"	610
HS-CLV-0075-EG	3/4"	610
HS-CLV-0100-EG	1"	610
HS-CLV-0125-EG	1 1/4"	610
HS-CLV-0150-EG	1 1/2"	610
HS-CLV-0200-EG	2"	610
HS-CLV-0250-EG	2 1/2"	1130
HS-CLV-0300-EG	3"	1130
HS-CLV-0400-EG	4"	1430
HS-CLV-0500-EG	5"	1430
HS-CLV-0600-EG	6"	1940
HS-CLV-0800-EG	8"	2000
HS-CLV-1000-EG	10"	3600
HS-CLV-1200-EG	12"	3800

UL EX 15800  
FM 3048552



### MODEL UB U-Bolt

MATERIAL: Electro-galvanized Steel  
APPLICATION: Standard U-bolt for IPS pipe size

CAT #	PIPE O.D	ROD SIZE	MAX LOAD (lbs)
HS-UB-0050-EG	1/2"	1/4"	485
HS-UB-0075-EG	3/4"	1/4"	485
HS-UB-0100-EG	1"	1/4"	485
HS-UB-0125-EG	1-1/4"	3/8"	1300
HS-UB-0150-EG	1-1/2"	3/8"	1300
HS-UB-0200-EG	2"	3/8"	1300
HS-UB-0250-EG	2-1/2"	1/2"	2260
HS-UB-0300-EG	3"	1/2"	2260
HS-UB-0400-EG	4"	1/2"	2260
HS-UB-0600-EG	6"	5/8"	3620
HS-UB-0800-EG	8"	5/8"	3620
HS-UB-1000-EG	10"	3/4"	5420
HS-UB-1200-EG	12"	7/8"	7540



## MODEL EMT-1PS EMT 1 HOLE STRAP

MATERIAL: Electro-galvanized Steel  
APPLICATION: support for horizontal runs  
of piping

CAT #	SIZE
HS-EMT-1PS-0050-EG	1/2"
HS-EMT-1PS-0075-EG	3/4"
HS-EMT-1PS-0100-EG	1"
HS-EMT-1PS-0125-EG	1 1/4"
HS-EMT-1PS-0150-EG	1 1/2"
HS-EMT-1PS-0200-EG	2"

UL E365032



## MODEL EMT-2PS EMT 2 HOLE STRAP

MATERIAL: Electro-galvanized Steel  
APPLICATION: support for horizontal runs  
of piping

CAT #	SIZE
HS-EMT-2PS-0050-EG	1/2"
HS-EMT-2PS-0075-EG	3/4"
HS-EMT-2PS-0100-EG	1"
HS-EMT-2PS-0125-EG	1 1/4"
HS-EMT-2PS-0150-EG	1 1/2"
HS-EMT-2PS-0200-EG	2"

UL E365032



### MODEL RSC-S SHORT RISER CLAMP

MATERIAL: Electro-galvanized Steel  
APPLICATION: Industrial pipe hanger.

CAT #	SIZE	MAX LOAD (Lbs)
HS-RSC-S-0050-EG	1/2"	500
HS-RSC-S-0075-EG	3/4"	500
HS-RSC-S-0100-EG	1"	500
HS-RSC-S-0125-EG	1 1/4"	800
HS-RSC-S-0150-EG	1 1/2"	1040
HS-RSC-S-0200-EG	2"	1040
HS-RSC-S-0250-EG	2 1/2"	1040
HS-RSC-S-0300-EG	3"	1040
HS-RSC-S-0400-EG	4"	1040
HS-RSC-S-0500-EG	5"	1040
HS-RSC-S-0600-EG	6"	1615
HS-RSC-S-0800-EG	8"	1615
HS-RSC-S-1000-EG	10"	2490



### MODEL RSC-L LONG RISER CLAMP

MATERIAL: Electro-galvanized Steel  
APPLICATION: For suspending vertical steel pipe risers.

CAT #	SIZE	MAX LOAD (Lbs)
HS-RSC-L-0075-EG	3/4"	220
HS-RSC-L-0100-EG	1"	220
HS-RSC-L-0125-EG	1 1/4"	250
HS-RSC-L-0150-EG	1 1/2"	250
HS-RSC-L-0200-EG	2"	300
HS-RSC-L-0250-EG	2 1/2"	400
HS-RSC-L-0300-EG	3"	500
HS-RSC-L-0400-EG	4"	750
HS-RSC-L-0500-EG	5"	1500
HS-RSC-L-0600-EG	6"	1600
HS-RSC-L-0800-EG	8"	2500
HS-RSC-L-1000-EG	10"	2500
HS-RSC-L-1200-EG	12"	2700



UL EX 28457  
FM 1951

### MODEL BCL-STD BEAM CLAMP STANDART

MATERIAL: Malleable iron

APPLICATION: Structural attachment for top or bottom of metal beams, purlins, channel or angle iron.

CAT #	ROD SIZE	THROAT OPENING	MAX LOAD(lbs)
HS-BCL-STD-0038-EG	3/8"	3/4"	610
HS-BCL-STD-0050-EG	1/2"	3/4"	1130
HS-BCL-STD-0062-EG	5/8"	3/4"	1130

UL E 484234



### MODEL BCL-LGE BEAM CLAMP LARGE

MATERIAL: Malleable iron

APPLICATION: Structural attachment for top or bottom of metal beams, purlins, channel or angle iron.

CAT #	ROD SIZE	THROAT OPENING	MAX LOAD(lbs)
HS-BCL-LGE-0038-EG	3/8"	1-1/4"	610
HS-BCL-LGE-0050-EG	1/2"	1-1/4"	1130
HS-BCL-LGE-0062-EG	5/8"	1-1/4"	1130

UL E 484234



### MODEL CCL C-CLAMP

MATERIAL: Malleable iron

APPLICATION: Structural attachment to top or bottom of metal beams, purlin or channels.

CAT #	ROD SIZE	THROAT OPENING	MAX LOAD(lbs)
HS-CCL-0038-PL	3/8"	7/8"	400

UL EX 389

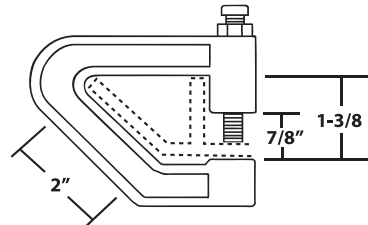

### MODEL RET BEAM CLAMP RETAINER STRAP

MATERIAL: Electro-galvanized Steel

APPLICATION: Retainer strap for beam .

CAT #	SIZE
HS-RET-0038-0600-EG	3/8" X 6"
HS-RET-0038-0800-EG	3/8" X 8"
HS-RET-0038-1000-EG	3/8" X 10"
HS-RET-0050-0600-EG	1/2" X 6"
HS-RET-0050-0800-EG	1/2" X 8"
HS-RET-0050-1000-EG	1/2" X 10"
HS-RET-0038-0400-EG	3/8" X 4"
HS-RET-0062-1000-EG	5/8" X 10"

UL E 484234



### MODEL CHN STRUT CHANNEL

MATERIAL: Electro-galvanized Steel  
APPLICATION: For individual fastening or efficiently constructing pipe routes.

CAT #	SIZE	CHANNEL TYPE	APPLICATION
HS-CHN-12-158-1316-LS-EG	1 5/8" x 1 3/16" 12G	C	Medium-heavy
HS-CHN-12-158-158-LS-EG	1 5/8" x 1 5/8" 12G	A	heavy
HS-CHN-14-158-1316-LS-EG	1 5/8" x 1 3/16" 14G	C	Light-medium
HS-CHN-14-158-158-LS-EG	1 5/8" x 1 5/8" 14G	A	Light-medium



### MODEL STC-EMT STRUT CLAMP FOR EMT

MATERIAL: Electro-galvanized Steel  
APPLICATION: For attaching EMT conduit pipe to strut channels.

CAT #	SIZE	MAX LOAD(lbs)
HS-STC-EMT-0050-EG	1/2"	400
HS-STC-EMT-0075-EG	3/4"	600
HS-STC-EMT-0100-EG	1"	600
HS-STC-EMT-0125-EG	1 1/4"	600
HS-STC-EMT-0150-EG	1 1/2"	200
HS-STC-EMT-0200-EG	2"	200

UL E358075



### MODEL STC-RGD STRUT CLAMP FOR RIGID

MATERIAL: Electro-galvanized Steel  
APPLICATION: For attaching RGD conduit or IPS size pipe to strut channels.

CAT #	SIZE	MAX LOAD(lbs)
HS-STC-RGD-0050-EG	1/2"	400
HS-STC-RGD-0075-EG	3/4"	600
HS-STC-RGD-0100-EG	1"	600
HS-STC-RGD-0125-EG	1 1/4"	600
HS-STC-RGD-0150-EG	1 1/2"	800
HS-STC-RGD-0200-EG	2"	800
HS-STC-RGD-0250-EG	2 1/2"	800
HS-STC-RGD-0300-EG	4"	1000
HS-STC-RGD-0400-EG	4"	1000
HS-STC-RGD-0500-EG	5"	1000
HS-STC-RGD-0600-EG	6"	1000
HS-STC-RGD-0800-EG	8"	1000

UL E358075



## MODEL STN-NSP STRUT NUT

MATERIAL: Electro-galvanized Steel  
APPLICATION: Non-spring nut for strut channel, type C

CAT #	ROD SIZE	CHANNEL TYPE
HS-STN-NSP-0038-EG	3/8"	C
HS-STN-NSP-0050-EG	1/2"	C
HS-STN-NSP-0062-EG	5/8"	C



## MODEL STN-SPR SPRING NUT

MATERIAL: Electro-galvanized Steel  
APPLICATION: For strut channel, type A

CAT #	ROD SIZE	SPRING LENGHT	CHANNEL TYPE
HS-STN-SPR-0038-EG	3/8"	1-1/2"	A
HS-STN-SPR-0050-EG	1/2"	1-1/2"	A
HS-STN-SPR-0062-EG	5/8"	1-1/2"	A



## MODEL STN-TSP TOP SPRING NUT

MATERIAL: Electro-galvanized Steel  
APPLICATION: For strut channel, type C

CAT #	ROD SIZE	FASTENER FOOT-LBS	CHANNEL TYPE
HS-STN-TSP-0038-EG	3/8"	19	C
HS-STN-TSP-0050-EG	1/2"	50	C
HS-STN-TSP-0062-EG	5/8"	80	C



**MODEL 2HA**  
**TWO HOLES CORNER ANGLE**

MATERIAL: Electro-galvanized Steel  
APPLICATION: Strut fittings

CAT #	SIZE
HS-2HA-0025-158-EG	1/4" X 1 5/8"

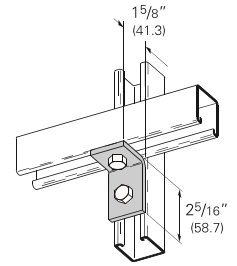

**MODEL 2HP**  
**TWO HOLES SLICE PLATE**

MATERIAL: Electro-galvanized Steel  
APPLICATION: Strut fittings

CAT #	SIZE
HS-2HP-314-158-EG	3 1/4 X 1 5/8"

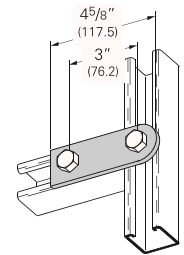

**MODEL 3HC**  
**THREE HOLES CORNER PLATE**

MATERIAL: Electro-galvanized Steel  
APPLICATION: Strut fittings

CAT #	SIZE
HS-3HC-312-312-EG	3 1/2" X 3 1/2"

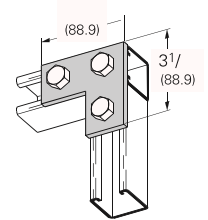

**MODEL 4HT**  
**FOUR HOLES TEE PLATE**

MATERIAL: Electro-galvanized Steel  
APPLICATION: Strut fittings

CAT #	SIZE
HS-4HT-538-312-EG	5 3/8" X 3 1/2"

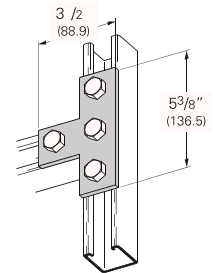

**MODEL 4HP**  
**FOUR HOLES TEE PLATE**

MATERIAL: Electro-galvanized Steel  
APPLICATION: Strut fittings

CAT #	SIZE
HS-4HP-312-312-EG	3 1/2" X 3 1/2"

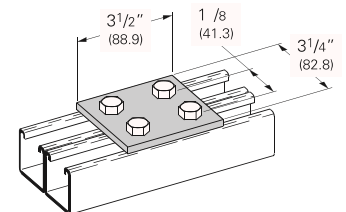



**MODEL 5HC**  
**FOUR HOLES TEE PLATE**

MATERIAL: Electro-galvanized Steel  
APPLICATION: Strut fittings

CAT #	SIZE
HS-5HC-312-312-EG	5 3/8" X 5 3/8"

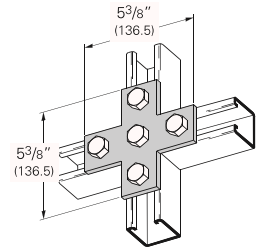

**MODEL PB4H**  
**POST BASE SQUARE FOR 1 5/8" STRUT**

MATERIAL: Electro-galvanized Steel  
APPLICATION: Strut fittings

CAT #	SIZE
HS-PB4H-158-EG	6 x 6"

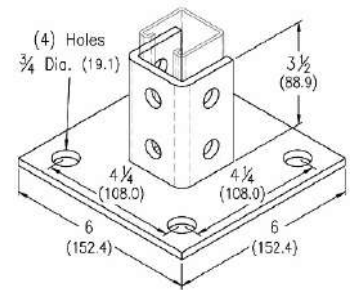

### MODEL DRO MINI DROP-IN ANCHOR STANDART DROP-IN ANCHOR

MATERIAL: Electro-galvanized steel  
APPLICATION: Concrete drop-in anchor

CAT #	ROD SIZE	MIN DEPTH	ANSI DRILL SIZE	LOAD CAP (Lbs)
HS-DRO-MIN-0037-EG	3/8"	3/4"	1/2"	530
HS-DRO-MIN-0050-EG	1/2"	1"	5/8"	840
HS-DRO-STD-0037-EG	3/8"	1 9/16"	1/2"	715
HS-DRO-STD-0050-EG	1/2"	2"	5/8"	1050
HS-DRO-STD-0062-EG	5/8"	2 1/2"	7/8"	1860



### MODEL TRA-CH / TRA-CV THREADED ROD ANCHOR

MATERIAL: Electro-galvanized steel  
APPLICATION: Easy 2 steps process anchoring on concrete:  
1/4" drill hole and drive anchor  
No included Retaining Nut

CAT #	ROD SIZE	SCREW TYPE	APPLICATION	MAX LOAD (Lbs)	DRIVE/ COLOUR
HS-TRA-CH-SWC20-EG	3/8"	5/16" x 1-3/4"	Horizontal	2450	HDRIVE
HS-TRA-CV-CST20-EG	3/8"	5/16" x 1-3/4"	Vertical	2450	VDRIVE
HS-TRA-VDRIVE			Drive Socket		BLACK
HS-TRA-HDRIVE			Drive Socket		RED

UL EX5098

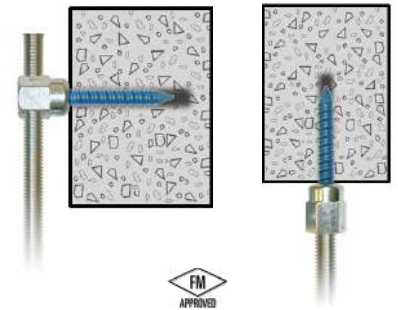

### MODEL TRA-SH / TRA-SV THREADED ROD ANCHOR

MATERIAL: Electro-galvanized steel  
APPLICATION: No pre-drilling anchoring for steel  
Included Retaining Nut

CAT #	ROD SIZE	SCREW TYPE	APPLICATION	MAX LOAD (Lbs)	DRIVE/ COLOUR
HS-TRA-SH-SWDR516-EG	3/8"	12-24 x 1-1/2"	Horizontal	2375	HDRIVE
HS-TRA-SV-DSTR516-EG	3/8"	12-24 x 1-1/2"	Vertical	1510	VDRIVE
HS-TRA-VDRIVE			Drive Socket		BLACK
HS-TRA-HDRIVE			Drive Socket		RED

UL EX5098

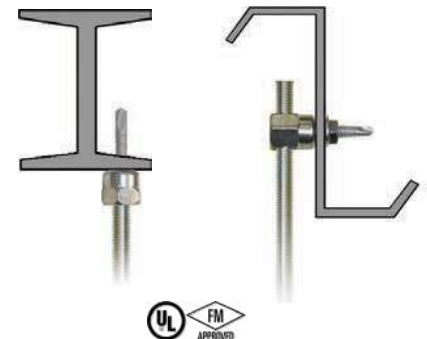

## MODEL WEA WEDGE EXPANSION ANCHOR

MATERIAL: Electro- galvanized steel

APPLICATION: Fully threaded, torque-controlled, wedge expansion anchor which is designed for consistent performance in cracked and uncracked concrete.

CAT #	SIZE
HS-WEA-0025-EG	1/4"
HS-WEA-0037-EG	3/8"
HS-WEA-0050-EG	1/2"
HS-WEA-0062-EG	5/8"
HS-WEA-0075-EG	3/4"
HS-WEA-0087-EG	7/8"
HS-WEA-0100-EG	1"
HS-WEA-0125-EG	1 1/4"



## Installation Specifications

ANCHOR PROPERTY/ SETTING INFORMATION	NOTATION	UNITS	NOMINAL ANCHOR DIAMETER							
			1/4	3/8	1/2	5/8	3/4	7/8	1	1-1/4
Anchor diameter	$d_a$	in. (mm)	0.250 (6.4)	0.375 (9.5)	0.500 (12.7)	0.625 (15.9)	0.750 (19.1)	0.875 (22.2)	1.000 (25.4)	1.250 (31.8)
Minimum diameter of hole clearance in fixture	$d_h$	in. (mm)	5/16 (7.5)	7/16 (11.1)	9/16 (14.3)	11/16 (17.5)	13/16 (20.6)	1 (25.4)	1-1/8 (28.6)	1-3/8 (34.9)
Nominal drill bit diameter	$d_{bit}$	in. ANSI	1/4" ANSI	3/8" ANSI	1/2" ANSI	5/8" ANSI	3/4" ANSI	7/8" ANSI	1" ANSI	1-1/4" ANSI
Minimum nominal embedment depth	$h_{nom}$	in. (mm)	1-1/8 (29)	1-5/8 (41)	2-1/4 (57)	2-3/4 (70)	3-3/8 (86)	4-1/2 (114)	4-1/2 (114)	6-1/2 (165)
Minimum hole depth	$h_o$	in. (mm)	1-1/4 (48)	1-3/4 (44)	2-1/2 (64)	3-1/8 (79)	3-5/8 (92)	4-7/8 (122)	4-7/8 (122)	7-1/4 (184)
Installation torque	$T_{inst}$	ft.-lbf. (N-m)	4 (5)	20 (27)	40 (54)	80 (108)	110 (149)	175 (237)	225 (305)	375 (508)
Torque wrench/ socket size	-	in.	7/16	9/16	3/4	15/16	1-1/8	1-5/16	1-1/2	1-7/8
Nut height	-	in.	7/32	21/64	7/16	35/64	41/64	3/4	55/64	1-1/16

For SI: 1 inch = 25.4 mm, 1 ft-lbf = 1.356 N-m.

1. The minimum base material thickness should be  $1.5h_{nom}$  or 3", whichever is greater.

## Installation Instructions

### Step 1

Using the proper drill bit size, drill a hole into the base material to the required depth.

### Step 2

Remove dust and debris.

### Step 3

If installing through a fixture.

### Step 4

Tighten the anchor with a torque wrench.

### MODEL ROD ALL THREAD RODS

MATERIAL: Hot dip galvanized steel  
APPLICATION: For attaching hanger to structural attachments

CAT #	SIZE
HS-ROD-0025-3M-EG	1/4"
HS-ROD-0037-3M-EG	3/8"
HS-ROD-0050-3M-EG	1/2"
HS-ROD-0062-3M-EG	5/8"
HS-ROD-0075-3M-EG	3/4"
HS-ROD-0087-3M-EG	7/8"



### MODEL SLW SPLIT LOCK WASHER

MATERIAL: Electro-galvanized steel  
APPLICATION: For locking nuts

CAT #	SIZE
HS-SLW-0025-EG	1/4"
HS-SLW-0037-EG	3/8"
HS-SLW-0050-EG	1/2"
HS-SLW-0062-EG	5/8"
HS-SLW-0075-EG	3/4"
HS-SLW-0087-EG	7/8"



### MODEL FW FLAT WASHER

MATERIAL: Electro-galvanized steel  
APPLICATION: Round steel flat washer

CAT #	SIZE
HS-FW-0025-EG	1/4"
HS-FW-0037-EG	3/8"
HS-FW-0050-EG	1/2"
HS-FW-0062-EG	5/8"
HS-FW-0075-EG	3/4"
HS-FW-0087-EG	7/8"



### MODEL SQW WASHER PLATE

MATERIAL: Electro-galvanized steel  
APPLICATION: Square nut for rod or U-Bolt

CAT #	ROD SIZE	OVERALL LENGTH
HS-SQW-0038-EG	3/8"	3"
HS-SQW-0050-EG	1/2"	3"
HS-SQW-0062-EG	5/8"	3"



### MODEL BOLT-H STEEL HEX BOLT

MATERIAL: Electro-zinc plated steel hex cap bolt  
APPLICATION: Steel hexagonal head bolt

CAT #	THREAD NPT	LENGTH
HS-BOLT-H-0038-XXXX	3/8"	1" to 12"
HS-BOLT-H-0050-XXXX	1/2"	1" to 12"
HS-BOLT-H-0062-XXXX	5/8"	1" to 12"
HS-BOLT-H-0075-XXXX	3/4"	1" to 12"



### MODEL NUT HEX NUT

MATERIAL: Electro-galvanized steel  
APPLICATION: Steel hexagonal nut

CAT #	SIZE
HS-NUT-0025-EG	1/4"
HS-NUT-0037-EG	3/8"
HS-NUT-0050-EG	1/2"
HS-NUT-0062-EG	5/8"
HS-NUT-0075-EG	3/4"
HS-NUT-0087-EG	7/8"



### MODEL RSC-S SHORT RISER CLAMP

MATERIAL: Electro-galvanized Steel  
APPLICATION: Industrial pipe hanger.

CAT #	SIZE	MAX LOAD (Lbs)
HS-RSC-S-0050-EG	½"	500
HS-RSC-S-0075-EG	¾"	500
HS-RSC-S-0100-EG	1"	500
HS-RSC-S-0125-EG	1 ¼"	800
HS-RSC-S-0150-EG	1 ½"	1040
HS-RSC-S-0200-EG	2"	1040
HS-RSC-S-0250-EG	2 ½"	1040
HS-RSC-S-0300-EG	3"	1040
HS-RSC-S-0400-EG	4"	1040
HS-RSC-S-0500-EG	5"	1040
HS-RSC-S-0600-EG	6"	1615
HS-RSC-S-0800-EG	8"	1615
HS-RSC-S-1000-EG	10"	2490



### MODEL HS-EZR SHORT RISER CLAMP

MATERIAL: Electro-galvanized steel  
APPLICATION: Suspending vertical steel pipe riser

CAT #	SIZE	MAX LOAD (Lbs)
HS-EZR-0050-EG	½"	255
HS-EZR-0075-EG	¾"	255
HS-EZR-0100-EG	1"	255
HS-EZR-0125-EG	1 ¼"	255
HS-EZR-0150-EG	1 ½"	255
HS-EZR-0200-EG	2"	255
HS-EZR-0250-EG	2 ½"	390
HS-EZR-0300-EG	3"	530
HS-EZR-0400-EG	4"	810
HS-EZR-0500-EG	5"	1160
HS-EZR-0600-EG	6"	1570



UL EX 2452

**MODEL SEI-UNIV**  
**UNIVERSAL STRUCTURAL ATTACHMENT**

MATERIAL: Electro-galvanized steel  
APPLICATION: Structural attachment  
for seismic applications

CAT #	SIZE	MAX LOAD (Lbs)
HS-SEI-UNIV-0050-EG	1/2"	2900



**MODEL SEI-HINGE**  
**SWAY BRACING HINGE**

MATERIAL: Electro-galvanized steel  
APPLICATION: Seismic hinge

CAT #	SIZE	MAX LOAD (Lbs)
HS-SEI-HINGE	1/2"	2900



## MODEL CSB EASY UNIVERSAL

MATERIAL: Electro-galvanized Steel  
APPLICATION: Use for both lateral and longitudinal sway brace applications

CAT #	SIZE	MAX LOAD (Lbs)	
		LATERAL	LONGITUDINAL
HS-CSB-0100-EG	1"	655	655
HS-CSB-0125-EG	1¼"	655	655
HS-CSB-0150-EG	1½"	655	655
HS-CSB-0200-EG	2"	655	655
HS-CSB-0250-EG	2½"	2045	1375
HS-CSB-0300-EG	3"	1600	700
HS-CSB-0400-EG	4"	20450	1375
HS-CSB-0500-EG	5"	20450	1375
HS-CSB-0600-EG	6"	1600	1100
HS-CSB-0800-EG	8"	20450	1375
HS-CSB-1000-EG	10"	20450	1885
HS-CSB-1200-EG	12"	20450	1885

UL EX3956  
FM 1950



## MODEL CSBQIKCL QUICK GRIP JR. LATERAL

MATERIAL: Electro-galvanized Steel  
APPLICATION: For lateral seismic sway braces; works with 1" and 1 1/4" (25 mm and 32 mm) brace pipes

CAT #	SIZE	MAX LOAD (Lbs)	
		25mm	32mm
HS-CSBQIKCL-0100-EG	1"	2910	2910
HS-CSBQIKCL-0125-EG	1¼"	2910	2400
HS-CSBQIKCL-0150-EG	1½"	3330	2910
HS-CSBQIKCL-0200-EG	2"	3330	2400

UL EX3956  
FM 1950

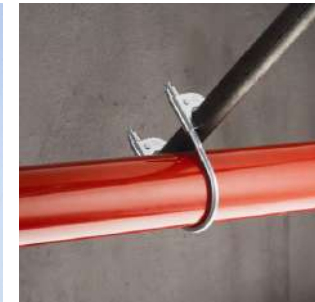

## MODEL CSBQG QUICK GRIP LATERAL

MATERIAL: Electro-galvanized Steel  
APPLICATION: For lateral seismic sway braces;  
works with 1" and 1 1/4"  
(25 mm and 32 mm) brace pipes

CAT #	SIZE	MAX LOAD (Lbs)
HS-CSBQG-0250-EG	2½"	2015
HS-CSBQG-0300-EG	3"	2015
HS-CSBQG-0400-EG	4"	2015
HS-CSBQG-0500-EG	5"	2015
HS-CSBQG-0600-EG	6"	2015
HS-CSBQG-0800-EG	8"	2015

UL EX3956  
FM 1950



## MODEL CSBU1 UNIVERSAL STRUCTURAL BRACKET

MATERIAL: Electro-galvanized steel  
APPLICATION: Structural attachment  
for seismic applications

CAT #	SIZE	MAX LOAD (Lbs)
HS-CSBU1-0050-EG	½"	3000

UL EX3956  
FM 1950



## MODEL SEI-4WY 4-WAY LONGITUDINAL SWAY BRACE ATTACHMENT

MATERIAL: Electro-galvanized Steel  
APPLICATION: For bracing pipe against sway  
and seismic disturbances

CAT #	BRACE PIPE SIZE	MAX LOAD (Lbs)
HS-SEI-4WY-0100-0100-EG	1" x 1"	655
HS-SEI-4WY-0100-0125-EG	1" x 1¼"	655
HS-SEI-4WY-0125-0125-EG	1¼" x 1¼"	655



TOLCO